

**LOS ANGELES COUNTY
DEPARTMENT OF PUBLIC WORKS**

BENCH MARK LIST



OTTERBEIN QUAD

1990 ADJUSTMENT

PREFACE 1990

The Department of Public Works level net is composed of more than 1,700 miles of levels supporting in excess of 9,000 bench marks. In 1990, a major readjustment of the Baseline and nets was undertaken. To emphasize the complete break with previous elevations, the CY, CG & CL series bench marks have been relabeled DY, DG, & DL, respectively.

To facilitate the adjustment, indexing, and distribution of adjusted values of the net, the County territory is divided into 33 quads or areas. For identification purposes each quad is given a name, viz., "Rosemead," "La Mirada," "Santa Fe", etc. When bench marks and elevations in these nets are used, the name of the quad and the date of the adjustment must be included in the bench mark description, e.g.,

DY 9701 - RDBM TAG IN CB 5FT S/O BCR @ SE COR BOLSA ST & DOMINGUEZ ST
63FT S & 20FT E/O C/L INT
(GARDENA - 1990) ELEV. 16.704

Experience indicates that this general adjustment will, for the most part, remain sound for the next 10 years. Updating constrained adjustments will be made in 5 years. It is expected that these updating adjustments will be in the nature of a few hundredths of a foot. When a quad is readjusted, new elevation lists will be published and the date of the readjustment will be noted in the bench mark description. Two bench marks with different adjustment dates will not normally agree with each other.

The basic accuracy of the net is reflected by an indicated field probable error of plus or minus 0.012 foot per mile of leveling as determined from over 600 conditions of closure. However, many years experience in vertical control in the greater Los Angeles basin and Antelope Valley indicate that because of varying degrees of subsidence and heaving, the true datum is recovered only by obtaining substantial agreement of a number of bench marks.

The users of this net are invited to assist in its maintenance by notifying this Department of cases of obliteration, apparent mistakes in descriptions or elevations, and proven disturbance of bench marks.

DATUM: U.S. Coast and Geodetic Survey Sea Level Datum
of 1929, through the medium of the Los Angeles
County Engineer Precise Level Net.

ABBREVIATIONS USED IN BENCH MARK LISTINGS

ABUT -----	Abutment	ECR -----	End of Curb Return
ALG -----	Along	EC -----	End of Curve
ANG PT -----	Angle Point	ENT -----	Entrance
B/W -----	Back of Walk	FL -----	Floor
BCR -----	Beginning of Curb Return	FTG -----	Footing
BC -----	Beginning of Curve	FRWY -----	Freeway
BLDG -----	Building	F/W -----	Front of Walk
BM -----	Bench Mark	GAR -----	Garage
BT SPK -----	Boat or Bolt Spike	HDWL -----	Headwall
BR CAP -----	Brass or Bronze Cap	HSE -----	House
C B -----	Catch Basin	HWY -----	Highway
CTR -----	Center	INT -----	Intersection
C/L -----	Center Line	IP -----	Iron Pipe
C/L INT -----	Center Line Intersection	LT -----	Left
C/L PROD -----	Center Line Produced	LACE -----	L.A. City Engineer
CONC -----	Concrete	LACS -----	L.A. Co. Engineer
COR -----	Corner	LAFC -----	L.A. Co. Flood Control
COE -----	Corps of Engineers	L&BN -----	Lead and Bench Nail
CULV -----	Culvert	L&BR -----	Lead and Brad
CYN -----	Canyon	L&N -----	Lead and Nail
CB -----	Curb	L&SPK -----	Lead and Spike
CS MON -----	Co. Eng. Monument	L&T -----	Lead and Tack
CT SPK -----	Cut Spike	MCR -----	Middle of Curb Return
DPW -----	Dept. of Public Works	MKD -----	Marked
DR -----	Drive or Driveway	MC -----	Middle of Curve
E/O -----	East of	MON -----	Monument

ABBREVIATIONS USED IN BENCH MARKS (CON'T)

N/O ----- North of
NR ----- Near
OPP ----- Opposite
PI ----- Point of Intersection
PK&W ----- PK Nail and Washer
P/L ----- Property Line
POST ----- Point of Semi-Tangent
PP ----- Power Pole
PVMT ----- Pavement
PROD ----- Produced
RD ----- Road
RDBM ----- Road Dept. Bench Mark
RDBM TAG ----- Road Dept. Bench Mark Tag
RR ----- Railroad
RT ----- Right
R/W ----- Right of Way
SDMH ----- Storm Drain Manhole
SMH ----- Sewer Manhole
SPK ----- Spike
ST&W ----- Spike Tin and Washer
S/O ----- South of
TP ----- Telephone Pole
USC&GS ----- U.S. Coast and Geodetic Survey
USGS ----- U.S. Geological Survey
WK ----- Walk
W/O ----- West of

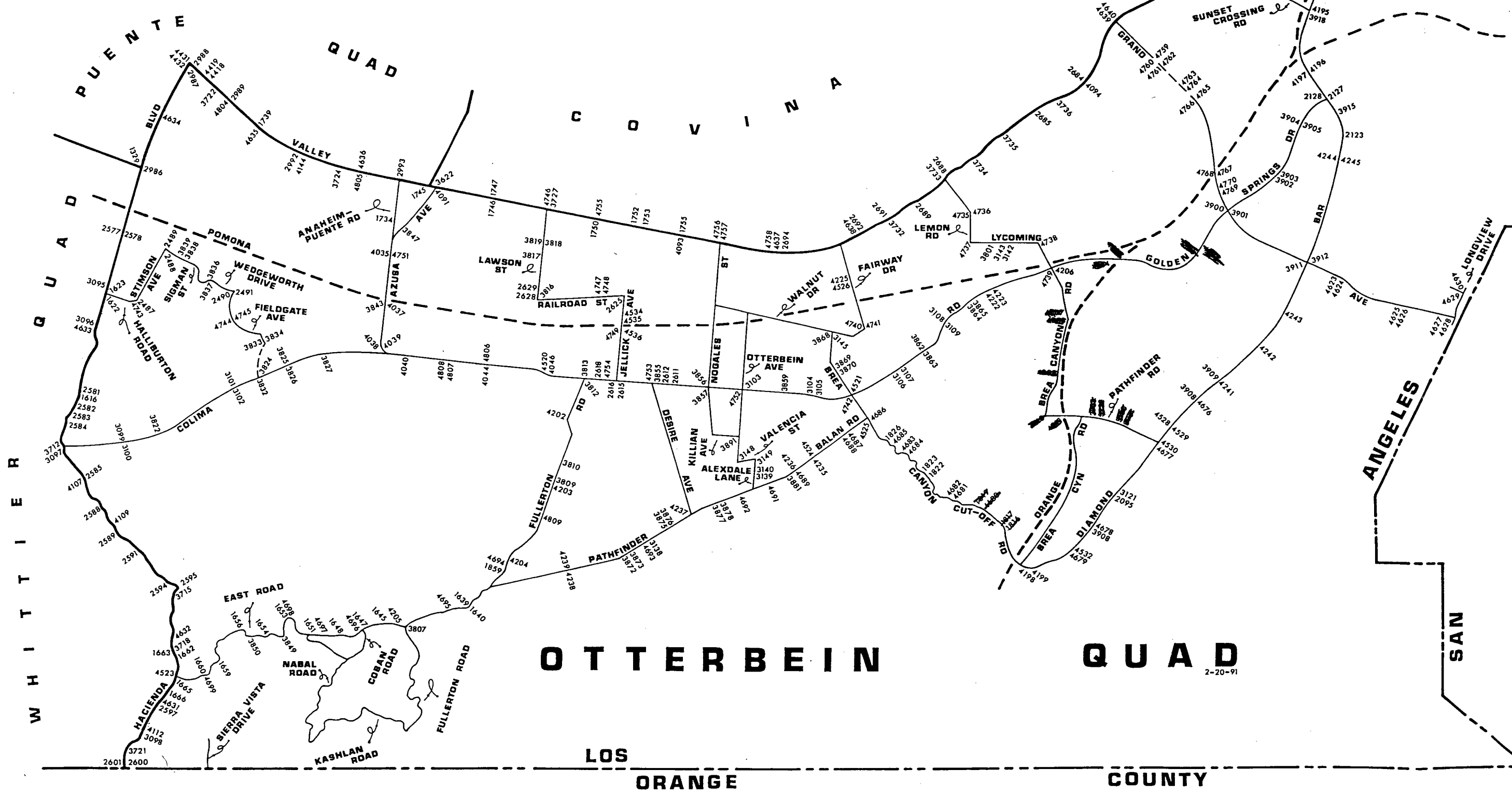

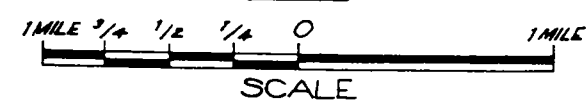
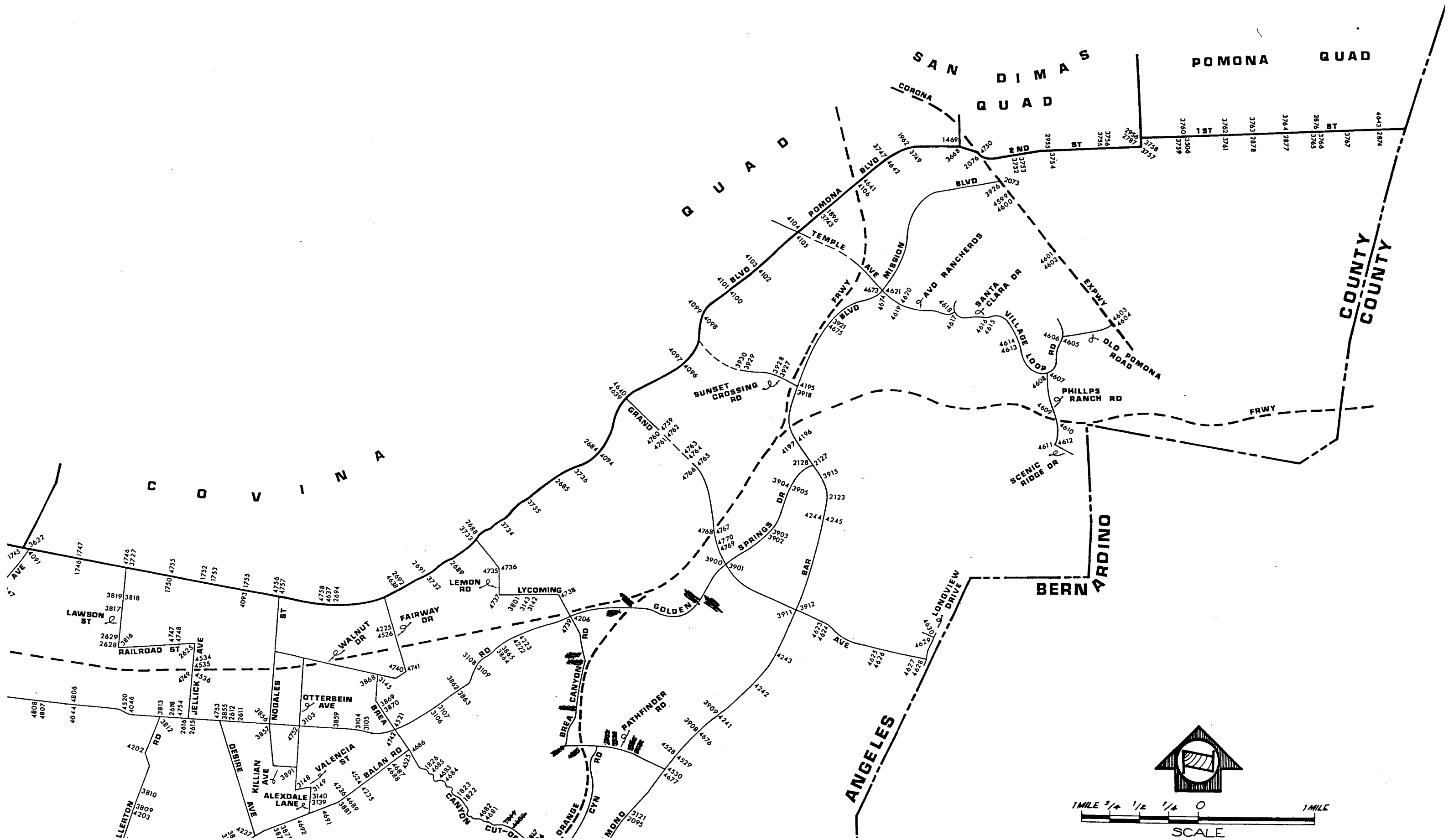

QUAD-YEAR	ELEV	DESCRIPTION (INCLUDE QUAD AND YEAR IN DESCRIPTION)	BM NUMBER
BASELINE (1990)	332.144	RDBM TAG N CB 9FT E BCR @ NW COR HACIENDA BLVD & GALE AVE 36FT N & 70FT W C/L INT	DG 1329
BASELINE (1990)	785.403	MWD BR MON FL IN HDWL 8FT N/O N RAIL SPRR 75FT S C/L MT VERNON AVE & 250FT W C/L BELLEVUE AVE MKD (62D 1933)	DG 1469
BASELINE (1990)	497.955	CS BRASS MON FL IN S WALL OF C B ON SE COR HACIENDA BLVD & LOS ALTOS DR 53FT S & 80FT E C/L INT MKD (BM 38-9A 1963)	DG 1616
BASELINE (1990)	406.206	RDBM TAG S CB & 1FT W BCR @ SE COR HACIENDA BLVD & HALLIBURTON RD & 40FT S C/L & 84FT E C/L INT	DG 1622
BASELINE (1990)	405.338	RDBM TAG N CB 1FT E BCR @ NE COR HACIENDA BLVD & HALLIBURTON RD 40FT N & 72FT E C/L INT	DG 1623
OTTRBEIN (1990)	659.129	RD MON IN WELL 8IN DN ON PI OF CURVE TO SW 12FT W/O C/L PVMT FULLERTON RD 30FT NW PP #875077E 0.65MI S/O SUNRISE DR MKD (1950)	DG 1639
OTTRBEIN (1990)	653.606	RD BM TAG IN S END CONC HDWL 30FT SE/O C/L FULLERTON RD 18FT S/O PP #875077E & 0.65MI S/O SUNRISE DR	DG 1640
OTTRBEIN (1990)	830.014	L&T CONC DR TO HSE NO 1505 EAST RD 27FT N C/L & 0.2 MI W FULLERTON RD @ SE COR GARAGE	DG 1645
OTTRBEIN (1990)	779.196	L&T CONC FOUNDATION OF W BRICK GATE POST @ HSE NO 1409 EAST RD 20FT N C/L 70FT E C/L COBAN RD & 0.4 MI W FULLERTON RD	DG 1647
OTTRBEIN (1990)	746.929	RDBM TAG N WINGWALL CONC HDWL 13FT E OF ENT TO HSE NO 1276 EAST RD 15FT S C/L & 0.6 MI W FULLERTON RD	DG 1648
OTTRBEIN (1990)	720.251	L&T CONC DR TO HSE NO 1141 EAST RD @ NW COR VALLE DR 75FT N & 15FT W/O C/L INT	DG 1651
OTTRBEIN (1990)	716.976	RDBM TAG CTR CONC HDWL OF DROP INLET 21FT N C/L EAST RD & 300FT W C/L PAPAYA DR	DG 1653
OTTRBEIN (1990)	708.323	RDBM TAG IN CTR CONC HDWL 15FT N C/L EAST RD E PP NO 1124854E & 240FT S/O DEEP CYN RD	DG 1654
OTTRBEIN (1990)	728.024	CHIS X IN W POST STEEL GUARD RAIL 17FT S C/L EAST RD 100FT E/O DR TO HSE NO 640 & 0.2 MI WLY OF ELY CHURCH-HILL RD	DG 1656

QUAD-YEAR	ELEV	DESCRIPTION (INCLUDE QUAD AND YEAR IN DESCRIPTION)	BM NUMBER
OTTRBEIN (1990)	650.038	CHIS X S POST OF STEEL GUARD RAIL 15FT W C/L EAST RD & 0.2MI W/O WLY INT CHURCH-HILL RD 84FT N/O HSE #378 & 9FT S/O PP #2129076E	DG 1659
OTTRBEIN (1990)	606.064	L&T NW CB EAST RD 15FT NW C/L 47FT N PP #212079E & 230FT S DR TO HSE #365 0.25MI W/O CHURCHILL RD (W'LY INT)	DG 1660
BASELINE (1990)	605.109	CSBM MON IN WELL 8IN DN ON C/L ENCANADA DR 48FT W C/L INT HACIENDA BLVD MKD (BM 38-4 1954)	DG 1662
BASELINE (1990)	605.245	CS MON FLUSH @ SW COR HACIENDA BLVD & ENCANADA DR 23FT W & 20FT S/O C/L INT (USE WEST EDGE)	DG 1663
BASELINE (1990)	555.093	L&T IN W END CONC STEP TO OFFICE @ SE COR HACIENDA BLVD & EAST RD 50FT E & 40FT S C/L INT MKD (BM)	DG 1665
BASELINE (1990)	512.655	L&BRAD 2FT S OF N END CONC HDWL OPP HSE NO 1703 HACIENDA BLVD 21FT E C/L & 0.15MI S EAST RD MKD (BM)	DG 1666
OTTRBEIN (1990)	376.532	L&T CONC RIM WATER VALVE BOX 45FT W C/L ANAHEIM-PUENTE RD & 550FT N/O RAILROAD ST 200FT S/O OFFICE OF DAY & NIGHT MFG CO (S EDGE DR OF GATE NO 1 - MKD BM)	DG 1734
BASELINE (1990)	343.593	RDBM TAG N CB 4FT E/O BC OF CB 20FT N/O C/L OLD VALLEY BLVD & 420FT E/O C/L VALLEY BLVD OVERPASS	DG 1739
BASELINE (1990)	379.459	RD MON IN WELL 7IN DN @ C/L INT VALLEY BLVD & AZUSA WAY	DG 1745
BASELINE (1990)	390.212	RD MON IN WELL 8IN DN ON C/L INT VALLEY BLVD & HAMBLEDON AVE	DG 1746
BASELINE (1990)	390.953	L&T N CB VALLEY BLVD 3FT E BCR @ NE COR HAMBLEDON AVE 36FT N & 47FT E C/L INT	DG 1747
BASELINE (1990)	412.479	L&BN IN RR SIGNAL BASE 75FT S C/L VALLEY BLVD & 35FT W C/L YORBITA RD	DG 1750
BASELINE (1990)	419.965	RDBM TAG W CB 11FT N BCR 81FT N C/L VALLEY BLVD & 20FT W C/L LA SEDA RD	DG 1752
BASELINE (1990)	420.038	L&T E CB 12FT N BCR 82FT N C/L VALLEY BLVD & 20FT E C/L LA SEDA RD	DG 1753
BASELINE (1990)	433.019	RDBM TAG N CB 1FT W CATCH BASIN 40FT N VALLEY BLVD & 0.2 MI E LA SEDA RD	DG 1755

QUAD-YEAR	ELEV	DESCRIPTION (INCLUDE QUAD AND YEAR IN DESCRIPTION)	BM NUMBER
OTTRBEIN (1990)	762.740	RDBM TAG NR CTR CONC HDWL 18FT N C/L BREA CANYON CUT OFF RD & 0.4MI N /O BREA CYN RD 25FT E/O PP #2316793E	DG 1816
OTTRBEIN (1990)	766.202	CS BR MON 2IN UP NR 2IN WHITE WITNESS PIPE 110FT N C/L BREA CANYON CUTOFF RD & 0.4MI N BREA CANYON RD 25FT W/O PP #2316793 MKD (BM 12E)	DG 1817
OTTRBEIN (1990)	821.857	RDBM TAG NR CTR CONC HDWL 15FT N C/L BREA CANYON CUTOFF RD & 0.7MI N BREA CANYON RD	DG 1819
OTTRBEIN (1990)	894.787	BT HD SPK IN CONC HDWL 21FT W C/L BREA CANYON CUT-OFF RD 0.2MI S/O OAKLEAF CYN RD 30FT S/O DRWY TO HSE NO 2545 (MKD BM NO 7)	DG 1822
OTTRBEIN (1990)	872.413	S & L IN E CONC HDWL 15FT W/O C/L BREA CYN CUT- OFF RD 0.15MI S/O OAK LEAF CYN RD (MKD BM NO 6)	DG 1823
OTTRBEIN (1990)	725.379	L&BN IN CONC HDWL OF PAVED RD TO WATER TANK 10FT N C/L 66FT W C/L BREA CANYON CUTOFF RD & 0.6 MI S COLIMA RD MKD (BM)	DG 1826
OTTRBEIN (1990)	629.241	L&BRAD IN N END HDWL 35FT W/O FULLERTON RD (TRAVELED ROAD) 80FT N/O PP #1073667E & 0.45MI S/O SUNRISE DR (NEAR WATER DIST OFFICE)	DG 1859
BASELINE (1990)	705.812	CSBM MON IN WELL 10IN DN 21FT N C/L POMONA BLVD & 0.1MI E C/L TEMPLE AVE 1FT N/O N EDGE CONC PVMT MKD (BM 11-90-1952)	DG 1896
BASELINE (1990)	771.187	RD BR CAP MON IN HDWL 80FT N'LY C/L POMONA BLVD 8FT S/O S RAIL SPRR 13FT E'LY C/L RIDGEWAY ST PROD 90FT S C/L MT VERNON AVE	DG 1962
OTTRBEIN (1990)	794.449	RDBM TAG 1FT N OF S END CONC HDWL @ NW COR 162FT W & 71FT N C/L INT CORONA EXPRESSWAY & MISSION BLVD	DG 2073
BASELINE (1990)	798.418	LACS MON IN WELL 13IN DN ON C/L 2ND ST IN MED ISL 2.5FT W/O END 310FT E C/L INT 2ND ST & HWY NO 71 (MKD BM 11-85)	DG 2076
OTTRBEIN (1990)	732.343	RDBM TAG 2FT S/O N END CONC HDWL 65FT E/O C/L DIAMOND BAR BLVD & 12FT N/O C/L FOUNTAIN SPRINGS RD	DG 2095
OTTRBEIN (1990)	841.872	RDBM TAG IN CTR CONC HDWL 77FT E C/L DIAMOND BAR BLVD & 233FT S'LY GOLDRUSH DR	DG 2123
OTTRBEIN (1990)	768.468	RDBM TAG IN W CB DIAMOND BAR BLVD 2FT S/O BCR @ SW COR DIAMOND BAR BLVD & GOLDEN SPRINGS DR 69FT S & 40FT W/O C/L INT	DG 2127

QUAD-YEAR	ELEV	DESCRIPTION (INCLUDE QUAD AND YEAR IN DESCRIPTION)	BM NUMBER
OTTRBEIN (1990)	762.994	RDBM TAG IN W CB DIAMOND BAR BLVD & 2FT N BCR @ NW COR DIAMOND BAR BLVD & GOLDEN SPRINGS DR 40FT W & 69FT N/O C/L INT	DG 2128
OTTRBEIN (1990)	420.938	CS TAG W CB 1FT N BCR @ NW COR HALLIBURTON RD & STIMSON AVE 87FT N & 30FT W C/L INT	DG 2487
OTTRBEIN (1990)	371.137	RAM SET S CB 1FT E BCR @ SE COR STIMSON AVE & SIGMAN ST 18FT S & 70FT E C/L INT MKD (SD 1223)	DG 2488
OTTRBEIN (1990)	370.569	RAM SET N CB 1FT E BCR @ NE COR STIMSON AVE & SIGMAN ST 18FT N & 69FT E C/L INT	DG 2489
OTTRBEIN (1990)	429.031	R E TAG NO 10103 1FT N BCR @ SW COR WEDGEWORTH DR & FIELDGATE AVE 45FT S & 18FT W/O C/L INT	DG 2490
OTTRBEIN (1990)	426.503	RE TAG NO 10103 E/O CB @ BCR & NE COR WEDGEWORTH DR & FIELDGATE AVE 45FT N & 20FT E/O C/L INT	DG 2491
BASELINE (1990)	360.985	L&T W CB HACIENDA BLVD 42FT W C/L @ C/L PROD SIGMAN ST	DG 2577
BASELINE (1990)	361.500	RDBM TAG S CB 17FT E/O BCR @ SE COR HACIENDA BLVD & SIGMAN ST 18FT S & 97FT E C/L INT CB	DG 2578
BASELINE (1990)	497.282	L&T N CB 3FT E BCR @ NE COR HACIENDA BLVD & LOS ALTOS DR 17FT N & 80FT E C/L INT	DG 2581
BASELINE (1990)	498.891	L&T E CB (W CB SERVICE ISLAND) HACIENDA BLVD 30FT S BCR @ SE COR LOS ALTOS DR 60FT S & 42 FT E C/L INT	DG 2582
BASELINE (1990)	519.887	L&BN E CB (W CB SERVICE ISLAND) HACIENDA BLVD 2FT N BCR @ NE COR DEL PRADO DR 30FT N & 45FT E C/L INT	DG 2583
BASELINE (1990)	521.967	L&BN E CB (W CB SERVICE ISLAND) HACIENDA BLVD 2FT S BCR @ SE COR DEL PRADO DR 35FT S & 45FT E C/L INT	DG 2584
BASELINE (1990)	602.944	RDBM TAG NLY CB 32FT ELY BCR 72FT ELY & 20FT NLY C/L INT HACIENDA BLVD & RICHVIEW DR	DG 2585
BASELINE (1990)	709.497	CSBM MON FL 22FT WLY C/L HACIENDA BLVD & 0.3MI SLY C/L RICHVIEW DR 6FT OFF EDGE OF PVMT 2FT NLY CONC HDWL MKD (BM 38-7 1954)	DG 2588
BASELINE (1990)	844.728	L&T IN CONC WALL OF DRAIN 15FT W APPROX C/L HACIENDA BLVD 0.7MI SLY INT HACIENDA BLVD & RICHVIEW DR MKD (BM)	DG 2589

QUAD-YEAR	ELEV	DESCRIPTION (INCLUDE QUAD AND YEAR IN DESCRIPTION)	BM NUMBER
BASELINE (1990)	897.390	CS BM MON IN WELL 9IN DN @ INT HACIENDA BLVD & SKYLINE DR 25FT W & 14FT N C/L INT MKD (BM-38-6 1954)	DG 2591
BASELINE (1990)	786.084	CS MON 2IN UP @ PI OF OLD RD ON SEMI-TAN GOING SLY 14FT N TP #W6384Y 30FT WLY C/L HACIENDA BLVD & 0.35MI SLY INT HACIENDA BLVD & SKYLINE DR USE S EDGE MKD (CO SUR RE 2177)	DG 2594
BASELINE (1990)	747.471	CS MON IN WELL 12IN DN 25FT E C/L HACIENDA BLVD & 4.6FT N C/L CANADA SOMBRA RD MKD (BM 38-5 1954)	DG 2595
BASELINE (1990)	495.754	L&T CONC RET WALL OF HSE ON NW COR HACIENDA BLVD & WEST RD 60FT NLY & 18FT WLY APPROX C/L INT	DG 2597
BASELINE (1990)	429.521	L&T S CB 1FT E BCR @ SE COR HACIENDA BLVD & JANINE DR 15FT S & 75FT E/O C/L INT	DG 2600
BASELINE (1990)	424.960	CS MON IN WELL 15IN DN ON C/L HACIENDA BLVD & 137FT S/O C/L JANINE DR @ INT OF ORANGE CO LINE	DG 2601
OTTRBEIN (1990)	477.233	RD BM TAG E CB 3FT S BCR @ SE COR COLIMA RD & PASO REAL AVE 80FT S & 18FT E C/L INT	DG 2611
OTTRBEIN (1990)	477.206	RD BM TAG W CB 3FT S BCR @ SW COR COLIMA RD & PASO REAL AVE 80FT S & 18FT W C/L INT	DG 2612
OTTRBEIN (1990)	463.089	CITY OF INDUSTRY BR MON IN CB @ SE COR COLIMA RD & JELICK AVE 42FT S & 53FT E/O C/L INT MKD (BENCH MARK 5-9)	DG 2615
OTTRBEIN (1990)	462.373	RDBM TAG S CB 40FT W BCR @ SW COR COLIMA RD & JELICK AVE 42FT S & 94FT W C/L INT	DG 2616
OTTRBEIN (1990)	464.012	CE BR MON IN CONC WK AROUND MH ON NW COR COLIMA RD & BATSON AVE 56FT N & 41FT W C/L INT MKD (BM 44-11A 1963 RE 5869)	DG 2618
OTTRBEIN (1990)	433.725	CITY OF INDUSTRY BR MON IN NW COR CONC FRAME AROUND GAS VALVES 30FT S/O C/L RAILROAD ST OPP BLDG #18451 & 0.25MI E/O C/L INT FULLERTON RD	DG 2625
OTTRBEIN (1990)	421.049	RDBM TAG W CB 1FT N BCR @ NW COR RAILROAD ST & LAWSON ST 45FT N & 18FT W INT	DG 2628
OTTRBEIN (1990)	418.693	CITY OF INDUSTRY BR MON W CB LAWSON ST 18FT W C/L & 472FT N/O INT RAILROAD ST MKD (BM 5-13)	DG 2629

QUAD-YEAR	ELEV	DESCRIPTION (INCLUDE QUAD AND YEAR IN DESCRIPTION)	BM NUMBER
BASELINE (1990)	576.921	RDBM TAG IN CONC FTG OF 5IN IP GUARD POST FOR 24IN WATER LINE 160FT E & 117FT S C/L INT VALLEY BLVD & BREA CANYON RD	DG 2684
BASELINE (1990)	548.202	FC BR MON FLUSH IN HDWL OF SPRR TRACK 81' S & 220' E/O APPROX C/L INT VALLEY BLVD & CARREY RD MKD (LACO FCD BM 102-18 1956)	DG 2685
BASELINE (1990)	518.181	R D MON IN WELL 8IN DN ON C/L VALLEY BLVD & 100FT W C/L LEMON AVE MKD (LA CO RD DEPT 196)	DG 2688
BASELINE (1990)	515.491	FC BR DISK E END HDWL 1210FT W LEMON RD & 22FT N OF N RAIL SPRR 70FT S C/L VALLEY BLVD & 0.1MI E BOURDET AVE MKD (FCD BM 102-14 1956)	DG 2689
BASELINE (1990)	510.124	RDBM TAG IN N CB VALLEY BLVD 1FT E/O BCR @ NE COR CASTLEHILL RD & VALLEY BLVD 40FT N & 75FT E C/L INT	DG 2691
BASELINE (1990)	489.139	CS BR CAP @ NW COR CATCH BASIN 41FT S & 270FT E C/L INT VALLEY BLVD & CAMINO TEODORA (TO THE NORTH) MKD (BM 11-100A 1962)	DG 2692
BASELINE (1990)	428.307	RDBM TAG NW COR OF 3X3FT CONC BASE OF BREATHER PIPE 58FT S C/L VALLEY BLVD & 700FT E SENTOUS AVE	DG 2694
BASELINE (1990)	846.107	L&BN E CB WHITE AVE 1FT N BCR @ NE COR 2ND ST 61FT N & 42FT E C/L INT	DG 2787
BASELINE (1990)	898.694	CS BR CAP MON FL 1FT S CF & 8FT W/O BCR S CB E FIRST ST @ SW COR EAST END AVE 84FT W & 21FT S C/L INT MKD (11-77-A 1959 CE RE 5869)	DG 2874
BASELINE (1990)	884.979	BR PLATE FL N END C B 30FT E C/L RESERVOIR ST 150FT N C/L E FIRST ST (MKD BM11-78A 1962 RE 5869)	DG 2876
BASELINE (1990)	876.783	L & BR E CB SAN ANTONIO AVE @ SE COR E FIRST ST 64FT S & 35FT E C/L INT	DG 2877
BASELINE (1990)	875.582	LACS BM MON FL @ SW ABUT OF BRIDGE OVER TOWNE AVE & 51FT W C/L 27FT S C/L FIRST ST MKD (CE BM 11-79A 1962 RE 5869)	DG 2878
BASELINE (1990)	823.823	CS MON IN WELL 8IN DN SW COR 2ND ST & OAK AVE 31FT S & 50FT W C/L INT MKD (BM 11-84A 1962)	DG 2955
BASELINE (1990)	850.663	CS BM MON FL IN HDWL 27FT S C/L FIRST ST & 84FT W WHITE AVE MKD (BM 11-83-A 1962 RE 5869)	DG 2956

QUAD-YEAR	ELEV	DESCRIPTION (INCLUDE QUAD AND YEAR IN DESCRIPTION)	BM NUMBER
BASELINE (1990)	332.908	CS MON FL IN C B ON SE COR HACIENDA BLVD & GALE AVE 22FT E/O BCR 42FT S & 105FT E/O C/L INT MKD (BM 38-13A 1963)	DG 2986
BASELINE (1990)	318.576	L&BN E CB 5FT N BCR @ SE COR VALLEY BLVD & HACIENDA BLVD 41FT E & 71FT S C/L INT MKD (BM)	DG 2987
BASELINE (1990)	318.254	RDBM TAG N CB 57FT E BCR @ NE COR VALLEY BLVD & HACIENDA BLVD 40FT N & 120FT E C/L INT	DG 2988
BASELINE (1990)	334.724	RDBM TAG W CB 1FT N BCR @ NW COR OLD VALLEY BLVD & ALBERT ST 46FT N & 18FT W C/L INT	DG 2989
BASELINE (1990)	353.949	RDBM TAG N CB NR W END C B 25FT N APPROX C/L N BARREL VALLEY BLVD NR INT OLD VALLEY BLVD 0.2MI W C/L FERRERO LN	DG 2992
BASELINE (1990)	376.376	RDBM TAG N CB VALLEY BLVD 40FT N C/L @ E END C B 175FT W/O APPROX C/L PROD ANAHEIM -PUENTE RD	DG 2993
BASELINE (1990)	402.591	CS BM MON IN WELL 8IN DN NE COR HACIENDA BLVD & HALLIBURTON RD 90FT N & 43FT E APPROX C/L INT MKD (BM 38-11A 1963)	DG 3095
BASELINE (1990)	436.231	CS BM MON IN WELL 8IN DN NW COR HACIENDA BLVD & TETLY ST 43FT W & 73FT N APPROX C/L INT MKD (BM 38-10A 1963)	DG 3096
BASELINE (1990)	553.970	CEBM MON FL IN CB ON SE COR HACIENDA BLVD & COLIMA RD 42FT S & 60FT E APPROX C/L INT MKD (BM 38-8A 1963)	DG 3097
BASELINE (1990)	491.249	RDBM TAG S CB 1FT E BCR @ SE COR HACIENDA BLVD & AVOCADO CREST 47FT E & 16FT S APPROX C/L INT	DG 3098
OTTRBEIN (1990)	645.708	RD BM TAG N CB 42FT N APPROX C/L COLIMA RD & 0.1MI E ALLENTON ST NEAR CREST OF HILL	DG 3099
OTTRBEIN (1990)	648.813	RD BM TAG S CB 42FT S APPROX C/L COLIMA RD & 0.1MI E ALLENTON ST NEAR CREST OF HILL	DG 3100
OTTRBEIN (1990)	626.937	RD BM TAG W CB 3FT N BCR @ NW COR COLIMA RD & PUNTA DEL ESTE DR 75FT N & 20FT W APPROX C/L INT	DG 3101
OTTRBEIN (1990)	627.201	L&T NE CB RET 12FT W BCR @ NE COR COLIMA RD & PUNTA DEL ESTE DR 42FT N & 38FT E APPROX C/L INT	DG 3102
OTTRBEIN (1990)	509.862	RD BM TAG N CB 6FT W BCR @ NE COR COLIMA RD & OTTERBEIN AVE 42FT N & 50FT E APPROX C/L INT	DG 3103

QUAD-YEAR	ELEV	DESCRIPTION (INCLUDE QUAD AND YEAR IN DESCRIPTION)	BM NUMBER
OTTRBEIN (1990)	528.853	RD BM TAG W CB 3FT N BCR @ NW COR COLIMA RD & YBARRA DR 80FT N & 18FT W C/L INT	DG 3104
OTTRBEIN (1990)	529.410	RD BM TAG E CB 1FT S BCR @ NE COR COLIMA RD & YBARRA DR 80FT N & 18FT E APPROX C/L INT	DG 3105
OTTRBEIN (1990)	591.964	RD BM TAG W CB 1FT S BCR @ SW COR COLIMA RD & LAKE CYN RD 77FT S & 30FT W C/L INT	DG 3106
OTTRBEIN (1990)	591.833	L&NAIL S CB NR BCR @ SE COR COLIMA RD & LAKE CYN RD 40FT S & 98FT E APPROX C/L INT	DG 3107
OTTRBEIN (1990)	583.266	RD BM TAG W CB 1FT N BCR @ NW COR COLIMA RD & CALBOURNE DR 80FT N & 18FT W C/L INT	DG 3108
OTTRBEIN (1990)	583.109	RD BM TAG E CB 1FT N BCR @ NE COR COLIMA RD & CALBOURNE DR 80FT N & 18FT E C/L INT	DG 3109
OTTRBEIN (1990)	733.431	L&T N CB FOUNTAIN SPRINGS RD 1FT W/O BCR @ NW COR DIAMOND BAR BLVD & FOUNTAIN SPRINGS RD 20FT N & 75FT W/O C/L INT	DG 3121
OTTRBEIN (1990)	616.193	CE TAG ELY CB 16FT S/O BCR SELY COR PATHFINDER RD & BLANDFORD DR 82FT SLY & 20FT ELY APPROX C/L INT	DG 3138
OTTRBEIN (1990)	614.066	L&BN E CB 27FT N/O ENT SW IND ELECT CO 18FT E/O C/L ALEXDALE LN & 312FT S/O INT AGUIRO ST FT OF PP # E64547Y	DG 3139
OTTRBEIN (1990)	600.435	RDBM TAG W CB 203FT N/O ENT TO SO-WEST IND ELECT CO 18FT W/O C/L ALEXDALE LANE 137FT S/O INT AGUIRO ST	DG 3140
OTTRBEIN (1990)	552.111	RE TAG S CB 1FT E BCR @ SE COR LYCOMING ST & PENARTH AVE 20FT S & 45FT E APPROX C/L INT	DG 3142
OTTRBEIN (1990)	550.945	RE TAG W CB 1FT S BCR @ SW COR LYCOMING ST & PENARTH AVE 50FT S & 18FT W APPROX C/L INT	DG 3143
OTTRBEIN (1990)	498.589	RDBM TAG S CB NR BCR @ SE COR BREA CYN CUTOFF RD & WALNUT DR 20FT S & 60FT E APPROX C/L INT	DG 3145
OTTRBEIN (1990)	546.314	LS TAG 2760 W CB OTTERBEIN AVE 18FT W APPROX C/L ABOUT 30FT S C/L PROD VALENCIA AVE	DG 3148
OTTRBEIN (1990)	551.006	CE TAG N CB VALENCIA AVE C/L PROD ALEXDALE LN	DG 3149
BASELINE (1990)	858.728	USC&GS MON FL @ W END C B 40FT E & 20FT N C/L INT FIRST ST & GORDON ST (MKD Q36 861 RESET 67)	DG 3506

QUAD-YEAR	ELEV	DESCRIPTION (INCLUDE QUAD AND YEAR IN DESCRIPTION)	BM NUMBER
BASELINE (1990)	379.903	L & BN @ NE COR FTG OF RR SIGNAL 80FT S & 125FT W C/L INT VALLEY BLVD & AZUSA AVE	DG 3622
BASELINE (1990)	783.628	RDBM TAG 21FT E/O END CB 16FT S C/L POMONA BLVD & 40FT W C/L BELLEVUE AVE PROD	DG 3668
BASELINE (1990)	553.980	RDBM TAG IN N CB 35FT E BCR 40FT N & 114FT E C/L INT HACIENDA BLVD & COLIMA RD	DG 3712
BASELINE (1990)	714.697	L & BN IN CONC FTG 1FT N/O S END BRICK WALL (AUSTIN HOMES TR) @ 2231 HACIENDA BLVD 26FT N LY & 35FT W LY C/L INT HACIENDA BLVD & PVT RD 0.05MI S C/L CANADA SOMBRA RD	DG 3715
BASELINE (1990)	605.269	LACS MON IN WELL 11IN DN @ C/L INT HACIENDA BLVD & ENCANADA DR	DG 3718
BASELINE (1990)	446.396	RAMSET @ BCR 50FT NLY & 83FT ELY C/L INT ESEVERRI LN & HACIENDA BLVD SERVICE RD	DG 3721
BASELINE (1990)	331.822	USGS MON FL IN VERT WALL @ NW COR BLDG 30FT S OLD VALLEY BLVD & 5FT W C/L PROD 1ST ST MKD (331)	DG 3722
BASELINE (1990)	362.497	LACS CONTROL SYS MON FL IN CTR CONC HDWL 64FT S C/L S BBL VALLEY BLVD & 390FT E C/L FERRERO LN 10FT N/O N RAIL SPRR MKD (H-11 RM NO 1 1958)	DG 3724
BASELINE (1990)	397.849	RDBM TAG IN CB 5FT W BCR 40FT N & 48FT W C/L INT VALLEY BLVD & GIANO AVE	DG 3727
BASELINE (1990)	507.965	CITY OF INDUSTRY BR MON IN N CB 2FT W/O BCR 42FT N & 73FT W C/L INT VALLEY BLVD & CASTLEHILL DR MKD (V 40)	DG 3732
BASELINE (1990)	519.377	RDBM TAG IN W CB 5FT S BCR 78FT N & 42FT W C/L INT VALLEY BLVD & LEMON AVE	DG 3733
BASELINE (1990)	529.582	RDBM TAG IN NW LY COR CONC BASE OF RR SIGNAL BOX 0.3MI E LY C/L LEMON AVE & 100FT S LY CTR MAC PVMT ON VALLEY BLVD 11FT S/O S RAIL SPRR	DG 3734
BASELINE (1990)	543.026	RDBM TAG NR CTR CB RET 65FT N & 30FT W/O C/L INT VALLEY BLVD & PIERRE RD	DG 3735
BASELINE (1990)	564.476	RDBM TAG IN NW LY COR CONC BASE RR SIGNAL NO A 0.2MI E/O SUZANNE RD 89FT S/O VALLEY BLVD (7FT S/O S RAIL SPRR)	DG 3736
BASELINE (1990)	709.819	RDBM TAG IN N CB 32FT N C/L POMONA BLVD 0.2MI NE TEMPLE AVE @ WLY EDGE OF W DRWY APRON TO REVERE EXTRUDERS INC 3255 POMONA BLVD	DG 3743

QUAD-YEAR	ELEV	DESCRIPTION (INCLUDE QUAD AND YEAR IN DESCRIPTION)	BM NUMBER
BASELINE (1990)	753.364	RDBM TAG IN S CB POMONA BLVD 32FT S & 175FT W/O C/L INT POMONA BLVD & PIONEER BLVD	DG 3747
BASELINE (1990)	770.904	RDBM TAG IN CONC FTG PUMP CONTROL BOX 59FT N/O N RAIL SPRR 20FT S LY & 30FT W LY C/L INT RIDGEWAY ST & MT VERNON AVE	DG 3749
BASELINE (1990)	814.271	RDBM TAG IN CB 7FT W/O BOX CULV 23FT N C/L 2ND ST & 110FT W/O SPRR TRACKS 0.25MI W C/L OAK AVE	DG 3752
BASELINE (1990)	814.294	RDBM TAG IN CB 6FT W BOX CULV 23FT S/O C/L 2ND ST & 110FT W/O RR TRACKS 0.25MI W/O C/L OAK AVE	DG 3753
BASELINE (1990)	825.104	RDBM TAG IN S CB 1FT E BCR 28FT S & 55FT E C/L INT 2ND ST & OAK AVE	DG 3754
BASELINE (1990)	836.625	RDBM TAG IN S CB 8FT W BCR 23FT S & 50FT W C/L INT 2ND ST & HAMILTON BLVD	DG 3755
BASELINE (1990)	837.721	RDBM TAG IN E CB 18FT N BCR 45FT N & 35FT E C/L INT 2ND ST & HAMILTON BLVD	DG 3756
BASELINE (1990)	845.861	RDBM TAG IN W CB 2FT S BCR 65FT S & 32FT W C/L INT 2ND ST & WHITE AVE	DG 3757
BASELINE (1990)	851.300	RDBM TAG IN S CB 30FT E BRIDGE ABUT 21FT S & 77FT E C/L INT FIRST ST & WHITE AVE	DG 3758
BASELINE (1990)	859.078	RDBM TAG IN N CB 20FT N & 5FT E C/L INT 1ST ST & S GORDON ST	DG 3759
BASELINE (1990)	857.190	RDBM TAG IN E CB 35FT S & 24FT E C/L INT 1ST ST & S GORDON ST	DG 3760
BASELINE (1990)	867.773	RDBM TAG N CB 5FT W/O BCR 20FT N & 60FT W C/L INT FIRST ST & PALOMARES ST	DG 3761
BASELINE (1990)	868.521	RDBM TAG IN S CB 1FT E BCR 20FT S & 59FT E C/L INT 1ST ST & PALOMARES ST	DG 3762
BASELINE (1990)	875.112	L & PK IN E END WINGWALL OF BRIDGE OVER TOWNE AV 26FT S & 79FT E C/L INT 1ST ST & TOWNE AVE	DG 3763
BASELINE (1990)	877.767	RDBM TAG IN N CB 6FT W/O END 20FT N & 72FT W C/L INT 1ST ST & SAN ANTONIO AVE	DG 3764
BASELINE (1990)	883.608	RDBM TAG IN N CB 20FT N & 92FT W C/L INT 1ST ST & RESERVOIR ST	DG 3765
BASELINE (1990)	882.874	RDBM TAG IN S CB 2FT E BCR 20FT S & 59FT E C/L INT 1ST ST & RESERVOIR ST	DG 3766

QUAD-YEAR	ELEV	DESCRIPTION (INCLUDE QUAD AND YEAR IN DESCRIPTION)	BM NUMBER
BASELINE (1990)	888.842	RDBM TAG IN CB 20FT S C/L 1ST ST @ E P/L WATER RESERVOIR 286FT E INT ELECTRA ST	DG 3767
OTTRBEIN (1990)	537.756	RDBM TAG IN CB 5FT E BCR 20FT S & 50FT E C/L INT LYCOMING ST & GLENWICK AVE	DG 3801
OTTRBEIN (1990)	874.294	RDBM MON IN WELL 8IN DN 85FT N & 30FT W C/L INT EAST RD & SKYLINE DR 2IN IP 3FT UP 1FT W	DG 3807
OTTRBEIN (1990)	534.710	LACE TAG IN CB 40FT S & 32FT W/O C/L INT MESCAL ST & FULLERTON RD	DG 3809
OTTRBEIN (1990)	516.267	L & CE TAG NO 10915 IN CB 1FT N BCR 55FT N & 32FT W/O C/L INT FULLERTON RD & GALATINA ST	DG 3810
OTTRBEIN (1990)	476.207	L & T IN CB 5FT N BCR 71FT S & 32FT W C/L INT COLIMA RD & FULLERTON RD MKD (BM)	DG 3812
OTTRBEIN (1990)	473.048	L & T IN CB 6FT W BCR 42FT N & 59FT E C/L INT COLIMA RD & FULLERTON RD TO THE N MKD (BM)	DG 3813
OTTRBEIN (1990)	421.329	RDBM TAG IN CB 10FT E BCR 20FT N & 77FT E C/L INT RAILROAD ST & LAWSON ST	DG 3816
OTTRBEIN (1990)	419.913	CITY OF INDUSTRY BR MON FLUSH @ C/L INT LAWSON ST & ROWLAND ST MKD (RE 5828)	DG 3817
OTTRBEIN (1990)	393.481	L & BN IN CONC FTG OF GATE POST 58FT E C/L LAWSON ST & 13FT S/O LA FC CHANNEL WALL MKD (BM)	DG 3818
OTTRBEIN (1990)	392.864	L & BN IN CONC FTG OF FENCE POST 66FT W C/L LAWSON ST & 13FT S LAFC CHANNEL WALL	DG 3819
OTTRBEIN (1990)	601.557	RDBM TAG IN NE COR C B 46FT N & 70FT W C/L INT COLIMA RD & STIMSON AVE	DG 3822
OTTRBEIN (1990)	582.060	RDBM TAG IN CB 42FT N C/L COLIMA RD & 0.25MI E PUNTA DEL ESTE DR 400FT W/O COUNTRY CYN DR	DG 3824
OTTRBEIN (1990)	489.697	RDBM TAG IN CONC CB 42FT S/O C/L COLIMA RD & 65FT E/O COUNTRYWOOD RD	DG 3825
OTTRBEIN (1990)	491.101	RDBM TAG IN CONC CB 8FT E/O BCR 42FT N/O C/L COLIMA RD & 74FT E/O COUNTRYWOOD RD	DG 3826
OTTRBEIN (1990)	465.408	RDBM TAG IN CB 4FT N BCR 75FT N & 20FT W C/L INT COLIMA RD & PARKLAWN RD	DG 3827
OTTRBEIN (1990)	587.436	RDBM TAG IN E EDGE C B 43FT S C/L COLIMA RD & 0.25MI E PUNTA DEL ESTE DR 475FT W/O C/1 COUNTRY CYN DR	DG 3832

QUAD-YEAR	ELEV	DESCRIPTION (INCLUDE QUAD AND YEAR IN DESCRIPTION)	BM NUMBER
OTTRBEIN (1990)	530.186	RDBM TAG IN C B 18FT E C/L PASO VERDE DR & 51FT S C/L CLEMINTINA DR	DG 3833
OTTRBEIN (1990)	526.353	RDBM TAG IN CB 3FT E BCR 18FT N & 48FT E C/L INT CLEMINTINA DR & PASO VERDE DR	DG 3834
OTTRBEIN (1990)	406.839	RE TAG #5406 CTR CONC WK @ MC 30FT E/O C/L GLENELDER AVE & 31FT N/O C/L WEDGEWORTH DR	DG 3836
OTTRBEIN (1990)	405.845	RE TAG # 5406 CTR CONC WK @ MC & HSE # 16242 30FT S/O C/L WEDGEWORTH DR & 30FT W/O C/L FLAMSTEAD DR	DG 3837
OTTRBEIN (1990)	381.959	RDBM TAG IN CB 4FT N BCR 42FT S'LY & 15FT E'LY C/L INT EASTLEIGH AVE & SIGMAN ST	DG 3838
OTTRBEIN (1990)	380.486	RDBM TAG IN CB @ E END C B 18FT N'LY & 64FT W'LY C/L INT SIGMAN ST & EASTLEIGH AVE	DG 3839
OTTRBEIN (1990)	436.691	RDBM TAG IN CB 24FT S BCR 90FT S & 40FT W C/L INT AZUSA AVE & POMONA FRWY OFF RAMP (E BOUND)	DG 3843
OTTRBEIN (1990)	721.971	RDBM TAG IN W EDGE CONC DR TO FIRE STA 24FT N C/L DEEP CYN RD & 145FT W C/L EAST RD	DG 3849
OTTRBEIN (1990)	730.223	RDBM TAG IN S CB EXIT DRWY TO HACIENDA GOLF CLUB 0.3 MI E/O WLY INT CHURCHILL RD 20FT SWLY/O C/L EAST RD 2FT S/O CB END	DG 3850
OTTRBEIN (1990)	469.694	L & RCE TAG # 10915 IN CB 1FT E/O BCR 42FT N & 66FT E/O C/L INT COLIMA RD & DESIRE AVE	DG 3855
OTTRBEIN (1990)	486.337	RDBM TAG IN CONC CB 38FT N BCR 112FT N & 42FT E/O C/L INT COLIMA RD & NOGALES ST	DG 3856
OTTRBEIN (1990)	488.203	RDBM TAG IN CB 2FT W/O BCR 78FT E & 46FT S/O C/L INT NOGALES ST & COLIMA RD	DG 3857
OTTRBEIN (1990)	523.338	L & LS TAG # 2825 IN CB 42FT S/O C/L COLIMA RD & 398FT E/O C/L BANIDA AVE 15FT W/O PP # 1654178E (TO THE SOUTH)	DG 3859
OTTRBEIN (1990)	597.414	L & T IN CB 15FT N BCR 66FT S & 22FT W C/L INT COLIMA RD & WALNUT LEAF DR	DG 3862
OTTRBEIN (1990)	596.302	RDBM TAG IN CB 7FT E BCR 42FT S & 63FT E C/L INT COLIMA RD & WALNUT LEAF DR	DG 3863
OTTRBEIN (1990)	566.869	L & LS TAG NO 3054 IN CB 1FT N BCR 80FT N & 18FT W C/L INT COLIMA RD & ARKLEY DR	DG 3864

QUAD-YEAR	ELEV	DESCRIPTION (INCLUDE QUAD AND YEAR IN DESCRIPTION)	BM NUMBER
OTTRBEIN (1990)	568.868	L & LS TAG NO 3054 IN CB 1FT W FUT BCR 42FT N & 54FT E C/L INT COLIMA RD & ARKLEY DR	DG 3865
OTTRBEIN (1990)	498.695	RDBM TAG IN CB 3FT S BCR 48FT S & 20FT W C/L INT WALNUT DR & BREA CYN CUTOFF RD	DG 3868
OTTRBEIN (1990)	518.967	L & LS TAG NO 3054 IN CB 20FT W C/L BREA CYN CUT-OFF RD @ S P/L HSE NO 1337 127FT N/O C/L SEARLS DR	DG 3869
OTTRBEIN (1990)	522.236	L & BN IN CONC FTG 6FT STEEL FENCE POST @ SW COR YBARRA SCHOOL YARD 30FT E/O C/L BR A CYN CUT-OFF RD & 47FT S/O C/L SEARLS DR	DG 3870
OTTRBEIN (1990)	623.310	RDBM TAG IN CB 84FT N & 20FT W C/L INT GALLIO AVE & PATHFINDER RD	DG 3872
OTTRBEIN (1990)	623.333	RDBM TAG IN CB 84FT N & 20FT E C/L INT GALLIO AVE & PATHFINDER RD	DG 3873
OTTRBEIN (1990)	578.771	RDBM TAG IN W END C B 41FT S/O C/L PATHFINDER RD 1128FT E/O INT BLANDFORD DR	DG 3875
OTTRBEIN (1990)	580.489	LACE TAG E END C B 41FT N/O C/L PATHFINDER RD 1145FT E/O INT BLANDFORD DR MKD (BM 11-78A-1962)	DG 3876
OTTRBEIN (1990)	591.297	LACE TAG W CB 1FT N/O BCR 115FT N & 20FT W C/L INT PASO REAL AVE & PATHFINDER RD (AGUIRO ST)	DG 3877
OTTRBEIN (1990)	592.181	RDBM TAG IN CB 2FT N BCR 91FT N & 20FT E C/L INT PATHFINDER RD & PASO REAL AVE	DG 3878
OTTRBEIN (1990)	607.158	L&BR NO CB BALAN RD 18FT N/O C/L & 180FT E/O INT EDMORE AVE	DG 3881
OTTRBEIN (1990)	524.019	LACS MON IN WELL 6IN DN @ C/L INT KILLIAN AVE OTTERBIEN AVE (USE S EDGE)	DG 3891
OTTRBEIN (1990)	742.736	RDBM TAG IN N EDGE C B 65FT S & 42FT W C/L INT GOLDEN SPRINGS DR & GRAND AVE	DG 3900
OTTRBEIN (1990)	736.488	RDBM TAG IN CB 1FT E BCR 32FT N & 80FT E C/L INT GOLDEN SPRINGS DR & GRAND AVE	DG 3901
OTTRBEIN (1990)	744.507	L&BRAD IN N CB COLD SPRING LANE 2FT W/O BCR 16FT S & 72FT W/O C/L INT DIAMOND BAR BLVD & COLD SPRING LANE	DG 3906
OTTRBEIN (1990)	813.739	L&RCE TAG #8793 IN W CB DIAMOND BAR BLVD 2FT N/O BCR 53FT S & 50FT W/O C/L INT DIAMOND BAR BLVD & KIOWA CREST DR	DG 3908

QUAD-YEAR	ELEV	DESCRIPTION (INCLUDE QUAD AND YEAR IN DESCRIPTION)	BM NUMBER
OTTRBEIN (1990)	826.703	L&LS TAG #2602 IN N CB ACACIA HILL DR 1FT W/O BCR 18FT N & 76FT W/O C/L INT DIAMOND BAR BLVD & ACACIA HILL DR	DG 3909
OTTRBEIN (1990)	895.683	L&T IN S CB GRAND AVE IN E END C B 44FT S & 96FT W/O C/L INT GRAND AVE & DIAMOND BAR BLVD MKD (BM C-12)	DG 3911
OTTRBEIN (1990)	896.078	L&T IN N CB GRAND AVE IN E END C B 43FT N & 96FT W/O C/L INT GRAND AVE & DIAMOND BAR BLVD MKD (BM C-11)	DG 3912
OTTRBEIN (1990)	814.092	RDBM TAG W CB DIAMOND BAR BLVD NR FIRE FLUG #351 48FT W/O C/L DIAMOND BAR BLVD & 0.15MI S/O GOLDEN SPRINGS DR	DG 3915
OTTRBEIN (1990)	695.026	RDBM TAG IN S CB SUNSET CROSSING RD 34FT E/O BCR 25FT S & 100FT E/O C/L INT DIAMOND BAR BLVD & SUNSET CROSSING RD	DG 3918
OTTRBEIN (1990)	767.919	L&LS TAG #2825 N CB HIGHLAND VALLEY RD 1FT E/O BCR 20FT N & 81FT E/O C/L INT DIAMOND BAR BLVD & HIGHLAND VALLEY RD	DG 3921
OTTRBEIN (1990)	872.869	SPK&L IN S CB SOLTAIRE ST 5FT S/O BCR 20FT W & 82FT S C/L IN DIAMOND BAR BLVD & SOLTAIRE ST	DG 3922
OTTRBEIN (1990)	796.021	RDBM TAG IN N END CONC HDWL 115FT N'LY ' 95FT E'LY C/L INT MISSION BLVD & CORONA EXPRESSWAY	DG 3926
OTTRBEIN (1990)	677.963	RDBM TAG IN CB 2FT W BCR 32FT N'LY & 55FT E'LY C/L INT SUNSET CROSSING RD & OLD TRAIL RD	DG 3927
OTTRBEIN (1990)	675.052	RDBM TAG IN CB 4FT W BCR OF ALLEY 32FT S'LY & 28FT W'LY C/L INT SUNSET CROSSING RD & OLD TRAIL ROAD	DG 3928
OTTRBEIN (1990)	650.529	L & LS TAG NO 2825 IN CB 32FT N'LY & 26FT W'LY C/L INT SUNSET CROSSING RD & BIG FALLS DR	DG 3929
OTTRBEIN (1990)	648.021	L & LS TAG NO 2825 IN CB 3FT E BCR OF ALLEY 32FT S'LY & 153FT W'LY C/L INT SUNSET CROSSING RD & BIG FALLS DR	DG 3930
OTTRBEIN (1990)	397.188	CITY OF INDUSTRY BR MON IN CB 4FT W BCR 32FT S & 78FT W C/1 INT AZUSA AVE & GALE AVE MKD (G-10A BM)	DG 4035
OTTRBEIN (1990)	436.871	L&T CTR CB RET 60FT E & 46FT S/O INT AZUSA AVE & POMONA FRWY EAST BOUND OFF RAMP	DG 4037

QUAD-YEAR	ELEV	DESCRIPTION (INCLUDE QUAD AND YEAR IN DESCRIPTION)	BM NUMBER
OTTRBEIN (1990)	455.922	RD BM TAG 6FT S/O BCR @ NW COR AZUSA AVE & COLIMA RD 88FT N & 42FT W/O C/L INT	DG 4038
OTTRBEIN (1990)	456.451	RD BM TAG 4FT N/O BCR @ NE COR AZUSA AVE & COLIMA RD 109FT N & 60FT E/O C/L INT	DG 4039
OTTRBEIN (1990)	464.521	RD BM TAG 7FT W/O BCR @ NE COR COLIMA RD & ENT TO ROBINSONS PARKING LOT (LA PUENTE SHOPPING CTR) 2FT S/O ST LITE NO 2026482E 55FT E & 43FT N/O C/L INT 0.1 MI E/O AZUSA AVE	DG 4040
OTTRBEIN (1990)	448.908	CITY OF INDUSTRY MON FL IN SE COR C.B 4FT S/O S CB & 46FT S/O C/L COLIMA RD & 0.55 MI W/O LARKVANE RD & 125FT W/O C/L WALNUT HALL RD MKD (BM CO - 4)	DG 4044
OTTRBEIN (1990)	487.084	RD BM TAG 2FT E/O BCR @ SE COR COLIMA RD & LARKVANE RD 46FT E & 45FT S/O C/L INT	DG 4046
BASELINE (1990)	379.333	CS MON @ E END CONC HDWL 62FT S C/L VALLEY BLVD & 124FT E C/L PROD AZUSA WAY 10FT N/O SPRR RAILS MKD (BM 11-106B 1971)	DG 4091
BASELINE (1990)	429.736	CITY OF INDUSTRY BM MON FL @ E END CONC HDWL 70FT S C/L VALLEY BLVD & 0.2MI E LA SEDA RD MKD (U-30)	DG 4093
BASELINE (1990)	577.607	L AFC DISC IN N WALL OF FC CHANNEL 5FT E/O NE COR OF BRIDGE 110FT S & 22FT E C/L INT VALLEY BLVD & BREA CANYON RD MKD (BM 103-00005)	DG 4094
BASELINE (1990)	648.250	L&T IN S CB VALLEY BLVD 42FT S & 0.55MI E GRAND AVE 5FT S/O PI MON NR BLDG NO 22064 E VALLEY BLVD	DG 4096
BASELINE (1990)	648.778	L&T IN MEDIAN CB 7FT S C/L VALLEY BLVD & 0.55MI E GRAND AVE OPP PI MON NR BLDG NO 22064 E VALLEY BLVD	DG 4097
BASELINE (1990)	652.560	RDBM TAG IN NLY WALL C B VALLEY BLVD 42FT ELY & 1.0MI NLY C/L GRAND AVE 62FT NLY N DR TO TELEDYNE BLDG NO 4200	DG 4098
BASELINE (1990)	656.895	RDBM TAG IN NLY WALL OF C B 42FT WLY C/L VALLEY BLVD & 1.0MI NLY OF C/L GRAND AVE & 247FT NLY OF N DR TO TELEDYNE BLDG # 4200	DG 4099
BASELINE (1990)	675.803	L&T IN ELY CB VALLEY BLVD @ S ELY END OF FC BRIDGE OVER SAN JOSE WASH 42FT ELY & 1.3MI N ELY GRAND AVE	DG 4100

QUAD-YEAR	ELEV	DESCRIPTION (INCLUDE QUAD AND YEAR IN DESCRIPTION)	BM NUMBER
BASELINE (1990)	675.193	L&T IN WLY CB VALLEY BLVD @ N WLY END OF FC BRIDGE OVER SAN JOSE WASH 42FT WLY & 1.3MI N ELY GRAND AVE	DG 4101
BASELINE (1990)	684.036	L&T IN CB 3FT S WLY C B 40FT NLY C/L VALLEY BLVD & 8FT ELY C/L POMONA BLVD 25FT ELY C/L DRIVEWAY INTO TRAILER PARK	DG 4102
BASELINE (1990)	686.295	L&T 4FT WLY BCR OF NOSE OF ISL 78FT SLY C/L VALLEY BLVD NR C/L PROD POMONA BLVD 86FT WLY INT SPRR TRACKS & POMONA BLVD	DG 4103
BASELINE (1990)	704.908	L&T @ MCR NE COR POMONA BLVD & TEMPLE AVE 39FT N/O C/L POMONA BLVD & 51FT E/O C/L TEMPLE AVE	DG 4104
BASELINE (1990)	704.899	L&T @ MCR @ SE COR POMONA BLVD & TEMPLE AVE 57FT E/O C/L TEMPLE AVE & 83FT S/O C/L POMONA BLVD	DG 4105
BASELINE (1990)	728.955	RDBM TAG CONC CB 2FT E/O BCR 32FT S C/L POMONA BLVD & 33FT E C/L DR BLDG NO 2882 179FT E C/L NO 57 FWY	DG 4106
BASELINE (1990)	603.679	CSBM MON FL IN NLY WALL C B 41FT WLY C/L HACIENDA BLVD & 40FT SLY C/L PROD RICHVIEW DR MKD (BM 38-7A 1975)	DG 4107
BASELINE (1990)	814.025	L&BN IN NE COR CONC HDWL 20FT W C/L HACIENDA BLVD & 0.55MI S C/L RICHVIEW DR	DG 4109
BASELINE (1990)	492.749	RDBM TAG IN W WALL C B 36FT E/O BCR @ SE COR AVACADO CREST RD & HACIENDA BLVD 18FT S & 78FT E C/L INT	DG 4112
BASELINE (1990)	357.552	L&BN E END CONC HDWL 88FT S C/L VALLEY BLVD 0.1MI W C/L FERRERO LN 5FT N/O N RAIL SPRR NR INT OF OLD VALLEY BLVD	DG 4144
OTTRBEIN (1990)	693.391	RDBM TAG 4FT S BCR @ NE COR DIAMOND BAR BLVD & COR DIAMOND BAR BLVD & SUNSET CROSSING RD 54FT N & 44FT E/O C/L INT	DG 4195
OTTRBEIN (1990)	724.432	RAM SET E CB DIAMOND BAR BLVD 1FT BACK OF CB 1FT N/O BCR @ NE COR DIAMOND BAR BLVD & PALOMINO DR 55FT N & 46FT E/O C/L INT	DG 4196
OTTRBEIN (1990)	726.287	RDBM TAG IN W CB DIAMOND BAR BLVD 34FT S/O BCR @ SW COR DIAMOND BAR BLVD & PALOMINO DR 75FT S & 51FT W/O C/L INT (N WALL C B)	DG 4197

QUAD-YEAR	ELEV	DESCRIPTION (INCLUDE QUAD AND YEAR IN DESCRIPTION)	BM NUMBER
OTTRBEIN (1990)	679.571	RDBM TAG IN W CB BREA CANYON RD 1FT S/O BCR @ NW COR BREA CANYON RD & DIAMOND BAR BLVD 70FT N & 32FT W/O CL INT	DG 4198
OTTRBEIN (1990)	679.765	RDBM TAG IN S CB DIAMOND BAR BLVD 1FT W/O BCR @ SW COR BREA CANYON RD & DIAMOND BAR BLVD 42FT S & 105FT W/O C/L INT	DG 4199
OTTRBEIN (1990)	503.613	RD BM TAG 1FT S/O BCR @ SW COR FULLERTON RD & CROSSHAVEN DR 45FT S & 32FT W/O C/L INT	DG 4202
OTTRBEIN (1990)	533.185	RD BM TAG 1FT N/O BCR @ NW COR FULLERTON RD & MESCAL ST 43FT N & 32FT W/O C/L INT	DG 4203
OTTRBEIN (1990)	611.197	RD BM TAG N END OF C B @ N ENT TO ROWLAND WATER DIST 0.3MI S/O SUNRISE DR & 18FT W/O CENTER OF TRAVEL FULLERTON RD	DG 4204
OTTRBEIN (1990)	867.723	RD BM TAG 1FT N/O BCR NE COR EAST RD & SKYLINE DR 40FT NLY & 13FT ELY/O C/L INT	DG 4205
OTTRBEIN (1990)	581.457	CSBM MON FLUSH IN CONC BASE VENT PIPE 7FT N/O BCR @ NW COR BREA CYN RD & COLIMA RD 100FT N & 45FT W/O C/L INT MKD (BM 44-4A 1971)	DG 4206
OTTRBEIN (1990)	572.357	CSBM MON IN E WALL C B 42FT N/O C/L COLIMA RD & 127FT E/O C/L LEMON AVE MKD (BM 44-5A 1975)	DG 4222
OTTRBEIN (1990)	569.812	RDBM TAG 2FT E/O END CB (FUTURE BCR) @ NW COR COLIMA RD & LEMON AVE 42FT N & 50FT W/O C/L INT	DG 4223
OTTRBEIN (1990)	483.910	RDBM TAG IN W WALL C B 41FT E/O BCR @ SE COR WALNUT DR & FAIRWAY DR 24FT S & 125FT E/O C/L INT	DG 4225
OTTRBEIN (1990)	603.646	RDBM TAG IN NO CB BALAN RD 5FT W/O BCR 49FT W & 20FT N/O C/L INT PEPPERDALE DR	DG 4235
OTTRBEIN (1990)	607.197	RDBM TAG IN N CB BALAN RD 5FT W/O BCR 51FT W & 20FT N/O C/L INT ARCDALE AVE & BALAN RD	DG 4236
OTTRBEIN (1990)	565.046	RDBM TAG NR SW COR CONC DR TO HSE NO 2454 DESIRE AVE 288FT N & 22FT E/O INT PATHFINDER RD	DG 4237
OTTRBEIN (1990)	653.236	L&LS TAG NO 2427 NR C/L NATIVE AVE 3FT S/O END DR TO HSE NO 2804 50FT N/O C/L PATHFINDER RD	DG 4238
OTTRBEIN (1990)	648.098	RDBM TAG NR E END CONC WK TO HSE NO 2799 NATIVE AVE 125FT W/O C/L & 150FT N/O C/L PATHFINDER RD	DG 4239

QUAD-YEAR	ELEV	DESCRIPTION (INCLUDE QUAD AND YEAR IN DESCRIPTION)	BM NUMBER
OTTRBEIN (1990)	824.899	L&LS TAG #2602 IN W CB DIAMOND BAR BLVD 1FT S/O BCR @ SW COR DIAMOND BAR BLVD & ACACIA HILL RD 48FT S & 50FT W/O C/L INT	DG 4241
OTTRBEIN (1990)	846.049	RDBM TAG IN S WALL C B 51FT W/O C/L DIAMOND BAR BLVD 428FT S/O C/L MOUNTAIN LAUREL (IN FRONT OF HSE #1729)	DG 4242
OTTRBEIN (1990)	877.776	RDBM TAG IN E CB DIAMOND BAR BLVD 2FT S/O BCR @ SE COR DIAMOND BAR BLVD & QUAIL SUMMIT DR 47FT S & 50FT E/O C/L INT	DG 4243
OTTRBEIN (1990)	913.665	RCE TAG #14010 IN S CB TIN DR 11FT W/O BCR @ SW COR DIAMOND BAR BLVD & TIN DR 26FT S & 75FT W/O C/L INT	DG 4244
OTTRBEIN (1990)	914.090	RCE TAG #14010 N CB TIN DR 11FT W/O BCR @ NW COR DIAMOND BAR BLVD & TIN DR 26FT N & 75FT W/O C/L INT	DG 4245
BASELINE (1990)	330.119	RCE TAG NO 5828 IN CB 3FT N/O BCR @ NE COR MAIN ST & GLENDORA AVE 51FT N & 44FT E/O C/L INT	DG 4418
BASELINE (1990)	328.986	RDBM TAG IN CB 1FT N/O BCR @ NW COR STAFFORD ST & GLENDORA AVE 85FT N & 30FT W/O C/L INT	DG 4419
BASELINE (1990)	321.489	RDBM TAG IN E CB 1FT S/O BCR @ SE COR STAFFORD ST & HACIENDA BLVD 112FT S & 46FT E/O C/L INT	DG 4431
BASELINE (1990)	321.865	RDBM TAG IN S CB 1FT W/O BCR @ SW COR STAFFORD ST & HACIENDA BLVD 58FT W & 46FT S/O C/L INT	DG 4432
OTTRBEIN (1990)	486.287	L&T 1FT N/O BCR 20FT W/O C/L LARKVANE RD & 72FT N/O C/L COLIMA RD	DG 4520
OTTRBEIN (1990)	569.766	RDBM TAG IN WLY WALL C B 42FT S/O C/L COLIMA RD & 203FT E/O C/L BREA CYN CUT OFF RD (70FT E/O BCR)	DG 4521
BASELINE (1990)	552.768	L&T IN C B 21FT N/O C/L EAST RD & 68FT E/O C/L HACIENDA BLVD	DG 4523
OTTRBEIN (1990)	603.872	RDBM TAG IN S CB BALAN RD 1FT W/O BCR 46FT W & 20FT S/O C/L INT PEPPERDALE DR	DG 4524
OTTRBEIN (1990)	641.734	RDBM TAG IN SE COR C B 64FT ELY C/L BREA CYN CUT OFF RD & 60FT SLY C/L ESQUILINE AVE	DG 4525
OTTRBEIN (1990)	484.313	RDBM TAG IN W WALL C B 24FT N/O C/L WALNUT DR & 105FT E/O C/L FAIRWAY DR	DG 4526

QUAD-YEAR	ELEV	DESCRIPTION (INCLUDE QUAD AND YEAR IN DESCRIPTION)	BM NUMBER
OTTRBEIN (1990)	782.031	L&BN IN W CB DIAMOND BAR BLVD 69FT N & 50FT W/O C/L INT DIAMOND BAR BLVD & MORNING CANYON RD	DG 4528
OTTRBEIN (1990)	780.097	L&RCE TAG #8793 IN W CB DIAMOND BAR BLVD 50FT W & 54FT S/O C/L INT DIAMOND BAR BLVD & MORNING CANYON RD	DG 4529
OTTRBEIN (1990)	771.030	L&T IN E CB DIAMOND BAR BLVD @ NE COR PATHFINDER RD & DIAMOND BAR BLVD 50FT E & 64FT N/O C/L INT (1FT N/O BCR)	DG 4530
OTTRBEIN (1990)	738.887	RD TAG IN WK 44FT E/O C/L DIAMOND BAR BLVD & 515FT N/O C/L CROOKED CREEK DR	DG 4532
OTTRBEIN (1990)	436.935	RDBM TAG IN CB 24FT W/O C/L JELLYCK AVE 150FT N/O END OF CUL DE SAC ON N SIDE OF POMONA FWY 0.10MI S/O MEHR AVE	DG 4534
OTTRBEIN (1990)	440.526	L&N IN W END CONC HDWL ON N SIDE POMONA FWY 27FT S/O END OF CUL DE SAC 8FT E/O C/L JELLYCK AVE 0.10MI S/O MEHR AVE	DG 4535
OTTRBEIN (1990)	440.595	RAMSET WITH CAL STATE DIV OF HWYS WASHER 20FT N/O C/L GREENBAY DR & 36FT E/O C/L JELLYCK AVE	DG 4536
OTTRBEIN (1990)	791.018	DPW BM TAG N CB @ NW COR BUTTERFIELD RD (W SERV. RD CORONA EXPWY) & 9TH ST 18FT N & 72FT W/O C/L INT (21FT W/O BCR)	DG 4599
OTTRBEIN (1990)	790.968	DPW BM TAG S CB @ SW COR BUTTERFIELD RD (W SERV. RD CORONA EXPWY) & 9TH ST 18FT S & 74FT W/O C/L INT (23FT W/O BCR)	DG 4600
OTTRBEIN (1990)	819.707	DPW BM TAG N CB @ NW COR CORONA EXPWY & N RANCH RD 21FT N & 195FT W/O C/L INT (OPP END WALL & NEAR BC OF CB)	DG 4601
OTTRBEIN (1990)	819.689	DPW BM TAG S CB @ SW COR CORONA EXPWY & N RANCH RD 21FT S & 195FT W/O C/L INT (OPP END WALL & NEAR BC OF CB)	DG 4602
OTTRBEIN (1990)	793.122	DPW BM TAG N CB @ NW COR CORONA EXPWY & OLD POMONA RD 34FT N & 205FT W/O C/L INT (1FT W/O W END C B)	DG 4603
OTTRBEIN (1990)	793.308	DPW BM TAG S CB @ SW COR CORONA EXPWY & OLD POMONA RD 34FT S & 205FT W/O C/L INT (1FT W/O W END C B)	DG 4604
OTTRBEIN (1990)	884.821	DPW BM TAG N CB @ NE COR OLD POMONA RD & VILLAGE LOOP RD 66FT E & 34FT N/O C/L INT (3FT E/O BCR)	DG 4605

QUAD-YEAR	ELEV	DESCRIPTION (INCLUDE QUAD AND YEAR IN DESCRIPTION)	BM NUMBER
OTTRBEIN (1990)	885.492	DPW BM TAG S CB @ SE COR OLD POMONA RD & VILLAGE LOOP RD 62FT E & 34FT S/O C/L INT (3FT E/O BCR)	DG 4606
OTTRBEIN (1990)	858.851	DPW BM TAG E CB @ SE COR PHILLIPS RANCH RD & VILLAGE LOOP RD 60FT S & 35FT E/O C/L INT (2FT S/O BCR)	DG 4607
OTTRBEIN (1990)	858.683	DPW BM TAG W CB @ SW COR PHILLIPS RANCH RD & VILLAGE LOOP RD 75FT S & 35FT W/O C/L INT (2FT S/O BCR)	DG 4608
OTTRBEIN (1990)	895.863	RAMSET (NAIL) IN NE COR OF LIGHT BASE #28/041 28FT S & 28FT W/O THE MOST SLY ON-RAMP TO WEST BOUND POMONA FRWY & PHILLIPS RANCH RD	DG 4609
OTTRBEIN (1990)	926.782	RAMSET (NAIL) IN SE COR CONC BRIDGE DECK @ PHILLIPS RANCH RD & POMONA FRWY OVERCROSSING (BR #53-2080 3FT N & 3FT E/O SE COR BRIDGE DECK)	DG 4610
OTTRBEIN (1990)	966.077	DPW BM TAG E CB @ NE COR PHILLIPS RANCH RD & SCENIC RIDGE DR 44FT N & 40FT E/O C/L INT (2FT N/O BCR)	DG 4611
OTTRBEIN (1990)	965.374	L&T W CB PHILLIPS RANCH RD 28FT N & 40FT W/O C/L INT SCENIC RIDGE DR & PHILLIPS RANCH RD	DG 4612
OTTRBEIN (1990)	911.672	DPW BM TAG IN E CB @ SE COR VILLAGE LOOP RD & OLD WOOD RD 54FT S & 28FT E/O C/L INT (2FT S/O BCR)	DG 4613
OTTRBEIN (1990)	912.577	DPW BM TAG IN E CB @ NE COR VILLAGE LOOP RD & OLD WOOD RD 48FT N & 28FT E/O C/L INT (2FT N/O BCR)	DG 4614
OTTRBEIN (1990)	934.067	DPW BM TAG N CB @ NE COR VILLAGE LOOP RD & SANTA CLARA RD 67FT E & 28FT N/O C/L INT (1FT E/O BCR)	DG 4615
OTTRBEIN (1990)	936.230	DPW BM TAG N CB @ NW COR VILLAGE LOOP RD & SANTA CLARA DR 54FT W & 28FT N/O C/L INT (1FT W/O BCR)	DG 4616
OTTRBEIN (1990)	1052.650	DPW BM TAG S CB @ SW COR SANTA CLARA DR & LOS FELIS DR 24FT S & 56FT W/O C/L INT (3FT W/O BCR)	DG 4617
OTTRBEIN (1990)	1053.293	DPW BM TAG N CB @ NW COR SANTA CLARA DR & LOS FELIS DR 24FT N & 52FT W/O C/L INT (1FT W/O BCR)	DG 4618
OTTRBEIN (1990)	961.574	DPW BM TAG S CB @ SE COR TEMPLE AVE & GOLDEN SPRINGS DR 24FT S & 69FT E/O C/L INT (3FT E/O BCR)	DG 4619

QUAD-YEAR	ELEV	DESCRIPTION (INCLUDE QUAD AND YEAR IN DESCRIPTION)	BM NUMBER
OTTRBEIN (1990)	957.059	DPW BM TAG S CB @ SW COR TEMPLE AVE & GOLDEN SPRINGS DR 36FT S & 68FT W/O C/L INT (1FT W/O BCR)	DG 4620
OTTRBEIN (1990)	896.877	DPW BM TAG S CB TEMPLE AVE @ SE COR 36FT S/O TEMPLE AVE & 90FT E/O DIAMOND BAR BLVD (2FT W/O BCR)	DG 4621
OTTRBEIN (1990)	982.872	DPW BM TAG W CB @ NW COR GRAND AVE & ROLLING KNOLL RD 48FT N & 40FT W/O C/L INT (1FT N/O BCR)	DG 4623
OTTRBEIN (1990)	990.514	RCE TAG #9757 W CB @ SW COR GRAND AVE & ROLLING KNOLL RD 50FT S & 40FT W/O C/L INT (1FT S/O BCR)	DG 4624
OTTRBEIN (1990)	1159.824	DPW BM TAG W CB @ NW COR GRAND AVE & SHOTGUN LN 48FT N & 42FT W/O C/L INT (1FT N/O BCR)	DG 4625
OTTRBEIN (1990)	1160.456	DPW BM TAG W CB @ SW COR GRAND AVE & SHOTGUN LN 48FT S & 42FT W/O C/L INT (1FT S/O BCR)	DG 4626
OTTRBEIN (1990)	1035.149	DPW BM TAG W CB @ NW COR GRAND AVE & LONGVIEW DR 52FT N & 44FT W/O C/L INT (1FT N/O BCR)	DG 4627
OTTRBEIN (1990)	1028.837	DPW BM TAG S CB @ SE COR LONGVIEW DR & GRAND AVE 25FT S & 75FT E/O C/L INT (9FT E/O BCR)	DG 4628
OTTRBEIN (1990)	1038.097	L&BRAD IN CB @ NW COR LONGVIEW DR & STARDUST DR 20FT N & 41FT W/O C/L INT (1FT W/O BCR)	DG 4629
OTTRBEIN (1990)	1039.199	L&BRAD IN CB @ NW COR LONGVIEW DR & STARDUST DR 20FT N & 41FT E/O C/L INT (NR WEST END C B)	DG 4630
BASELINE (1990)	497.075	L&BRAD IN SW COR CONC HDWL 45FT N & 20FT E/O C/L INT HACIENDA BLVD & WEST RD	DG 4631
BASELINE (1990)	663.382	CE TAG N END CONC HDWL @ OR NEAR C/L PROD REPOSADO DR 27FT W/O C/L HACIENDA BLVD	DG 4632
BASELINE (1990)	438.762	DPW BM TAG IN CB @ SW COR HACIENDA BLVD & TETLEY ST 20FT S & 66FT W/O C/L INT (1FT W/O BCR)	DG 4633
BASELINE (1990)	319.847	L&PK IN CB @ NW COR HACIENDA BLVD & DON JULIAN RD 34FT N & 62FT W/O C/L INT (16FT E/O BCR)	DG 4634
BASELINE (1990)	343.368	DPW BM TAG S CB 4FT E/O BC OF CB 20FT S/O C/L OLD VALLEY BLVD & 420FT E/O C/L VALLEY BLVD OVERPASS (42FT S/O PP #215724)	DG 4635
BASELINE (1990)	372.358	DPW BM TAG IN CB @ NW COR VALLEY BLVD & WICKFORD AVE 42FT N & 55FT W/O C/L INT (1FT W/O BCR)	DG 4636

QUAD-YEAR	ELEV	DESCRIPTION (INCLUDE QUAD AND YEAR IN DESCRIPTION)	BM NUMBER
BASELINE (1990)	472.331	L&RCE TAG #5828 IN CB @ NE COR VALLEY BLVD & SENTOUS AVE 48FT N & 65FT E/O C/L INT (1FT E/O BCR)	DG 4637
BASELINE (1990)	486.503	L&T IN CB @ NW COR VALLEY BLVD & CAMINO TEODORA (TO THE NORTH) 44FT N & 35FT W/O C/L INT (8FT E/O BCR)	DG 4638
BASELINE (1990)	608.234	L&T IN SE COR C B @ NW COR VALLEY BLVD & GRAND AVE 80FT N & 45FT W/O C/L INT (5FT N/O BCR)	DG 4639
BASELINE (1990)	608.685	USC&GS MON IN SW COR C B @ NE COR GRAND AVE & VALLEY BLVD 90FT N & 45FT E/O C/L INT MKD NL 1329 1978) 5FT N/O BCR	DG 4640
BASELINE (1990)	729.188	USC&GS DISC 33FT N/O C/L POMONA BLVD & 185FT E/O C/L #57 FRWY @ SW COR OF CB MKD (G1329-1978)	DG 4641
BASELINE (1990)	755.804	L&T IN SO CB POMONA BLVD ON C/L PROD OF PIONEER PL (32FT S/O C/L POMONA BLVD)	DG 4642
BASELINE (1990)	897.663	DPW BM TAG E CB 60FT S & 40FT E/O C/L INT 1ST ST & EAST END AVE (5FT S/O BCR @ SE COR)	DG 4643
OTTRBEIN (1990)	888.615	DPW BM TAG N CB TEMPLE AVE @ NW COR 46FT N/O TEMPLE AVE & 85FT W/O DIAMOND BAR BLVD (3FT E/O BCR)	DG 4673
OTTRBEIN (1990)	873.803	DPW BM TAG IN N CB DIAMOND BAR BLVD @ BCR W END C B 42FT N & 51FT E/O C/L INT DIAMOND BAR BLVD & SOLTAIRE ST	DG 4674
OTTRBEIN (1990)	768.647	DPW BM TAG W CB DIAMOND BAR BLVD 3FT S/O BCR @ SW COR 60FT S & 43FT W C/L INT DIAMOND BAR BLVD & HIGHLAND VALLEY RD	DG 4675
OTTRBEIN (1990)	815.418	DPW BM TAG W CB DIAMOND BAR BLVD IN N END C B 5FT N/O BCR @ NW COR KIOWA CREST DR & DIAMOND BAR BLVD 62FT N & 50FT W/O C/L INT	DG 4676
OTTRBEIN (1990)	772.238	DPW BM TAG IN W CB DIAMOND BAR BLVD S END C B 27FT N/O BCR @ NW COR PATHFINDER RD & DIAMOND BAR BLVD 102FT N & 50FT W/O C/L INT	DG 4677
OTTRBEIN (1990)	745.398	DPW BM TAG IN E CB DIAMOND BAR BLVD 3FT S/O BCR @ SE COR COLD SPRINGS LANE & DIAMOND BAR BLVD 52FT S & 42FT E/O C/L INT	DG 4678
OTTRBEIN (1990)	721.936	L&BRAD IN W CB DIAMOND BAR BLVD 2FT S/O BCR @ NW COR CROOKED CREEK DR & DIAMOND BAR BLVD 55FT N & 42FT W/O C/L INT	DG 4679

QUAD-YEAR	ELEV	DESCRIPTION (INCLUDE QUAD AND YEAR IN DESCRIPTION)	BM NUMBER
OTTRBEIN (1990)	806.722	DPW BM TAG IN NW COR CONC HDWL 92FT N/O C/L BREA CANYON CUT-OFF RD 80FT W/O C/L BRIDGE #B761 0.70MI N/O BREA CANYON RD	DG 4680
OTTRBEIN (1990)	887.499	DPW BM TAG 38FT W/O BCR W END C B @ NW COR 140FT W/O C/L (NEW) BREA CANYON CUT-OFF RD & 32FT N/O PATHFINDER RD	DG 4681
OTTRBEIN (1990)	884.012	DPW BM TAG @ NE COR S END C B 152FT N/O C/L PATHFINDER RD & 36FT E/O C/L (NEW) BREA CANYON CUT-OFF RD	DG 4682
OTTRBEIN (1990)	806.070	L&T IN W CB BREA CANYON CUT-OFF RD N END C B @ SW COR OF BREA CANYON CUT-OFF RD & OAKLEAF CANYON RD 32FT W & 43FT S/O C/L INT	DG 4683
OTTRBEIN (1990)	802.446	L&T IN N CB OAKLEAF CANYON RD E END C B @ NW COR OF BREA CANYON CUT-OF RD & OAKLEAF CANYON RD 58FT W & 18FT N/O C/L INT	DG 4684
OTTRBEIN (1990)	733.483	DPW BM TAG S END C B 60FT S/O MAIN ENTRANCE TO SUNSET RIDGE HOMES & 35FT E/O C/L BREA CANYON RD 3FT N/O PP #298082E (0.2MI S/O ESQUILINE AVE)	DG 4685
OTTRBEIN (1990)	635.069	DPW BM TAG IN E CB BREA CANYON CUT-OFF RD 10FT N/O BCR @ NE COR BREA CANYON CUT-OFF RD & ESQUILINE AVE 53FT N & 45FT E/O C/L INT	DG 4686
OTTRBEIN (1990)	665.203	DPW BM TAG IN S CB BALAN RD 5FT E/O BCR W END C B @ SE COR BALAN RD & FRANCES LN 48FT E & 20FT S/O C/L INT	DG 4687
OTTRBEIN (1990)	662.948	DPW BM TAG W CB FRANCES LN 5FT S/O BCR N END C B @ SW COR BALAN RD & FRANCES LN 20FT W & 50FT S/O C/L INT	DG 4688
OTTRBEIN (1990)	614.931	DPW BM TAG S CB BALAN RD 22FT E/O BCR E END C B @ SE COR BALAN RD & ARCDAL E AVE 63FT E & 22FT S/O C/L INT	DG 4689
OTTRBEIN (1990)	635.611	L&BRAD IN W CB ANNADEL AVE 3FT N/O BCR @ NW COR ANNADEL AVE & PATHFINDER RD 20FT W & 60FT N/O C/L INT	DG 4690
OTTRBEIN (1990)	633.852	DPW BM TAG IN S CB PATHFINDER RD @ BCR SW COR PATHFINDER RD & ANNADEL AVE 32FT S & 46FT W/O C/L INT	DG 4691
OTTRBEIN (1990)	616.667	L&BRAD S CB PATHFINDER RD 3FT W/O BCR @ SW COR PATHFINDER RD & SONG BIRD LN 32FT S & 48FT W/O C/L INT	DG 4692

QUAD-YEAR	ELEV	DESCRIPTION (INCLUDE QUAD AND YEAR IN DESCRIPTION)	BM NUMBER
OTTRBEIN (1990)	617.990	DPW BM TAG S CB 21FT W/O BCR @ SW COR PATHFINDER RD & BLANDFORD DR 41FT S & 66FT W/O C/L INT	DG 4693
OTTRBEIN (1990)	604.255	DPW BM TAG @ SE COR CONC FTG OF MIRA LOMA OLINDA TOWER #29-1A 275FT E/O FULLERTON RD (TRAVELED RD) 400FT S/O ENT CHURCH OF NAZARENE 0.5MI S/O SENTENO ST	DG 4694
OTTRBEIN (1990)	707.450	L&BRAD @ SW COR CONC DR TO HSE #2360 FULLERTON RD 2FT N & 2FT E/O 2X2 BRICK PILLAR 36FT E/O C/L FULLERTON RD & 0.8MI S/O SUNRISE DR	DG 4695
OTTRBEIN (1990)	779.301	DPW BM TAG IN CONC HDWL ACROSS FROM DR TO HSE #1409 EAST RD 18FT S & 71FT E/O C/L INT EAST RD & COBIN RD	DG 4696
OTTRBEIN (1990)	722.416	LACS TAG IN N END CONC HDWL @ SW COR EAST RD & TUMIN RD 12FT S & 93FT W/O C/L INT	DG 4697
OTTRBEIN (1990)	727.660	DPW BM TAG IN E SIDE CONC DR TO HACIENDA GOLF COURSE TEE #14 100FT W/O C/L PAPAYA DR & 25FT N/O C/L EAST RD	DG 4698
OTTRBEIN (1990)	626.831	DPW BM TAG IN N EDGE CONC DR 2FT S & 2FT E/O CONC BLOCK PILLAR 39FT W/O C/L EAST RD @ HSE #365 0.2MI W/O WLY INT CHURCHILL RD	DG 4699
OTTRBEIN (1990)	524.805	DPW BM TAG IN CB 1FT N/O BCR @ NW COR LEMON AVE & BUSINESS PKWY 40FT W & 86FT N/O C/L INT	DG 4735
OTTRBEIN (1990)	525.755	DPW BM TAG IN W CB 5FT S/O BCR @ SW COR LEMON AVE & BUSINESS PKWY 40FT W & 90FT S/O C/L INT	DG 4736
OTTRBEIN (1990)	531.095	RCE TAG #12559 IN W CB 42FT W/O LEMON AVE ON C/L PROD OF LYCOMING ST	DG 4737
OTTRBEIN (1990)	560.602	DPW BM TAG IN N CB 1FT W/O BCR @ NW COR LYCOMING ST & BREA CYN RD 20FT N & 85FT W/O C/L INT	DG 4738
OTTRBEIN (1990)	580.360	DPW BM TAG IN E CB 47FT N/O BCR @ NE COR BREA CYN RD & GOLDEN SPRINGS DR 42FT E & 120FT N/O C/L INT	DG 4739
OTTRBEIN (1990)	504.555	DPW BM TAG @ NW COR 43FT W/O C/L FAIRWAY DR & 56FT N/O C/L WALNUT DR (1FT N/O BCR)	DG 4740
OTTRBEIN (1990)	506.154	L&T @ SW COR 43FT W/O C/L FAIRWAY DR & 49FT S/O C/L WALNUT DR (1FT S/O BCR)	DG 4741
OTTRBEIN (1990)	568.320	L&T @ NE COR 42FT E/O C/L FAIRWAY DR & 90FT N/O C/L COLIMA RD (1FT N/O BCR)	DG 4742

QUAD-YEAR	ELEV	DESCRIPTION (INCLUDE QUAD AND YEAR IN DESCRIPTION)	BM NUMBER
OTTRBEIN (1990)	420.725	DPW BM TAG @ NE COR 111FT N/O C/L HALLIBURTON RD 30FT E/O C/L STIMPSON AVE (1FT N/O BCR)	DG 4743
OTTRBEIN (1990)	479.974	DPW BM TAG @ SE COR 46FT S/O C/L HALLIBURTON RD 47FT E/O C/L PASO VERDE DR (1FT E/O BCR)	DG 4744
OTTRBEIN (1990)	483.677	DPW BM TAG @ SW COR 46FT S/O C/L HALLIBURTON DR & 43FT W/O C/L PASO VERDE DR (5FT W/O BCR)	DG 4745
BASELINE (1990)	398.467	DPW BM TAG IN N CB @ NE COR VALLEY BLVD & GIANO 40FT N & 45FT E/O C/L INT (1FT E/O BCR)	DG 4746
OTTRBEIN (1990)	427.932	RCE TAG #20330 @ NW COR FULLERTON RD & RAILROAD ST 32FT W & 70FT N/O C/L INT (5FT N/O BCR)	DG 4747
OTTRBEIN (1990)	427.893	RCE TAG #20330 @ NE COR FULLERTON RD & RAILROAD ST 32FT E & 75FT N/O C/L INT (5FT N/O BCR)	DG 4748
OTTRBEIN (1990)	440.815	DPW BM TAG @ SE COR JELLYCK AVE & GREENBAY DR 20FT E & 44FT S/O C/L INT (1FT S/O BCR)	DG 4749
BASELINE (1990)	798.927	L&N S CB 2ND ST 327FT E & 29FT S/O C/L INT 2ND ST & HWY #71 (1FT E/O E WALL C B)	DG 4750
OTTRBEIN (1990)	396.293	DPW BM TAG @ SE COR 30FT S/O C/L GALE AVE & 88FT E/O C/L AZUSA AVE (1FT E/O BCR)	DG 4751
OTTRBEIN (1990)	506.872	DPW BM TAG W CB 1FT N/O BCR @ NW COR COLIMA RD & OTTERBEIN AVE 77FT N & 21FT W/O C/L INT	DG 4752
OTTRBEIN (1990)	469.018	RCE TAG #10915 IN N CB 1FT W/O BCR 42FT N & 66FT W/O C/L INT COLIMA RD & DESIRE AVE	DG 4753
OTTRBEIN (1990)	463.338	DPW BM TAG S CB 4FT E/O BCR @ SE COR COLIMA RD & BATSON AVE 42FT S & 60FT E/O C/L INT	DG 4754
BASELINE (1990)	409.494	DPW BM TAG IN N CB 10FT W/O E END C B @ NW COR VALLEY BLVD & YORBITA RD 46FT N & 40FT W/O C/L INT	DG 4755
BASELINE (1990)	456.264	RD BM TAG W CB 43FT N/O BCR @ NW COR NOGALES ST & VALLEY BLVD 43FT W & 142FT N/O C/L INT (2FT N/O N END C B)	DG 4756
BASELINE (1990)	456.414	DPW BM TAG E CB 56FT N/O BCR @ NE COR NOGALES ST & VALLEY BLVD 42FT E & 142FT N/O C/L INT (1FT N/O N END C B)	DG 4757
BASELINE (1990)	469.690	L&RCE TAG #5828 N CB 1FT W/O BCR @ NW COR VALLEY BLVD & SENTOUS AVE 42FT N & 70FT W/O C/L INT	DG 4758

QUAD-YEAR	ELEV	DESCRIPTION (INCLUDE QUAD AND YEAR IN DESCRIPTION)	BM NUMBER
OTTRBEIN (1990)	604.097	L&BR S CB VALLEY BLVD 114FT W/O C/L GRAND AVE 42FT S/O C/L VALLEY BLVD	DG 4759
OTTRBEIN (1990)	604.964	L&BR W CB @ NW COR BRIDGE OVER SAN JOSE CREEK 748FT S/O C/L VALLEY BLVD & 45FT W/O C/L GRAND AVE	DG 4760
OTTRBEIN (1990)	603.864	L&BR TOP CONC HDWL 31FT N/O CTR UPRR 228FT E/O C/L GRAND AVE & 2440FT S/O C/L VALLEY BLVD	DG 4761
OTTRBEIN (1990)	600.596	L&BR TOP CONC HDWL 31FT N/O CTR UPRR 195FT W/O C/L GRAND AVE & 2490FT S/O C/L VALLEY BLVD	DG 4762
OTTRBEIN (1990)	628.622	L&BR CTR CONC HDWL EQUESTRIAN TUNNEL 81FT W/O C/L GRAND AVE & 2918FT S/O C/L VALLEY BLVD	DG 4763
OTTRBEIN (1990)	632.566	L&BR NE COR CONC HDWL EQUESTRIAN TUNNEL 75FT E/O C/L GRAND AVE & 2908FT S/O C/L VALLEY BLVD	DG 4764
OTTRBEIN (1990)	676.540	L&BR CTR CONC HDWL 80FT E/O C/L GRAND AVE & 3718FT S/O C/L VALLEY BLVD	DG 4765
OTTRBEIN (1990)	693.536	1 1/2IN IP CONC PLUG W SPK & W 63FT W/O C/L GRAND AVE & 3758FT S/O C/L VALLEY BLVD	DG 4766
OTTRBEIN (1990)	731.946	L&BR CONC FTG 6FT CHAIN LINK FENCE 54FT W/O C/L GRAND AVE & 0.75MI N/O C/L GOLDEN SPRINGS DR	DG 4767
OTTRBEIN (1990)	729.496	L&BR CONC HDWL 62FT E/O C/L GRAND AVE & 0.75MI N/O C/L GOLDEN SPRINGS DR	DG 4768
OTTRBEIN (1990)	699.238	L&T ON CONC CB 42FT E/O C/L GRAND AVE & 0.35MI N/O GOLDEN SPRINGS DR	DG 4769
OTTRBEIN (1990)	699.907	L&T ON E CB ISLAND @ C/L GRAND AVE & 0.35MI N/O C/L GOLDEN SPRINGS DR	DG 4770
BASELINE (1990)	335.076	RCE TAG #5828 N CB 1FT E/O BCR @ NE COR OLD VALLEY BLVD & ALBERT ST 20FT N/O & 45FT E/O C/L INT	DG 4804
BASELINE (1990)	372.977	DPW BM TAG N CB 7FT E/O BCR & NE COR VALLEY BLVD & WICKFORD AVE 42FT N/O & 57FT E/O C/L INT W END C B	DG 4805
OTTRBEIN (1990)	448.760	DWP BM TAG N CB W WALL C B COLIMA RD & WALNUT HALL RD 42FT N/O & 120FT W/O C/L INT	DG 4806
OTTRBEIN (1990)	456.154	DWP BM TAG 1FT N/O BCR @ NE COR COLIMA RD & ALBATROSS ST 79FT N/O & 32FT E/O C/L INT	DG 4807

QUAD-YEAR	ELEV	D E S C R I P T I O N (INCLUDE QUAD AND YEAR IN DESCRIPTION)	BM NUMBER
OTTRBEIN (1990)	455.449	DWP BM TAG 1FT N/O BCR N END OF DRWY @ NW COR COLIMA RD & ALBATROSS ST 114FT N/O & 32FT W/O C/L INT	DG 4808
OTTRBEIN (1990)	550.991	DPW BM TAG 2FT S/O BCR @ EC SE COR FULLERTON RD & SENTENO ST 44FT S & 30FT E/O C/L INT	DG 4809